

STEP 1.
Place Cable Holder onto the Aluminum Rail.
STEP 2.
With all monitors, accessories and Wire Management in place, decide where to place the Cable Holder.
Choose the best position and slide the Cable Holder in most desirable position.
STEP 3.
Push cables into the Cable Holder.

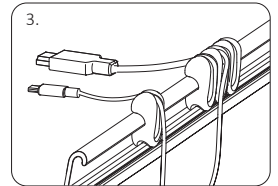

STEP 1.
Place Cable Holder onto the Aluminum Rail.
STEP 2.
With all monitors, accessories and Wire Management in place, decide where to place the Cable Holder.
Choose the best position and slide the Cable Holder in most desirable position.
STEP 3.
Push cables into the Cable Holder.

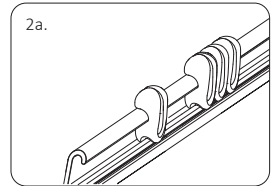
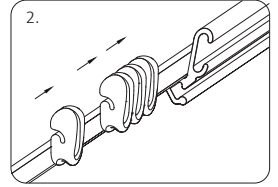
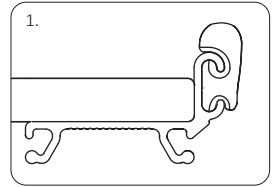
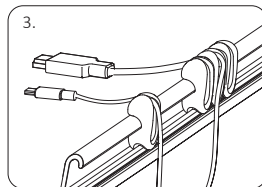
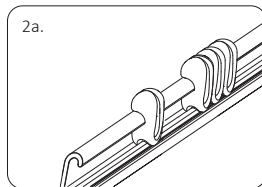
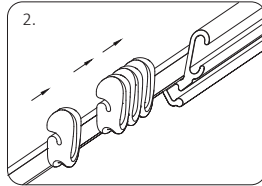
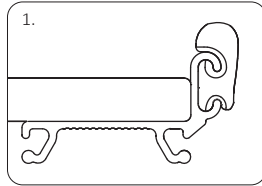

STEP 1.
Place Cable Holder onto the Aluminum Rail.
STEP 2.
With all monitors, accessories and Wire Management in place, decide where to place the Cable Holder.
Choose the best position and slide the Cable Holder in most desirable position.
STEP 3.
Push cables into the Cable Holder.

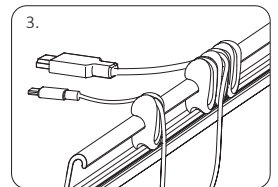
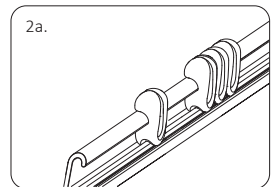
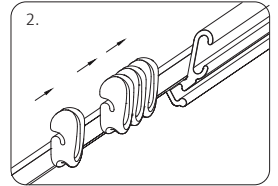
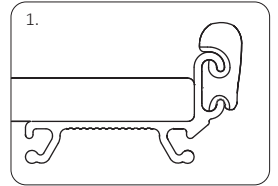

STEP 1.
Place Cable Holder onto the Aluminum Rail.
STEP 2.
With all monitors, accessories and Wire Management in place, decide where to place the Cable Holder.
Choose the best position and slide the Cable Holder in most desirable position.
STEP 3.
Push cables into the Cable Holder.